

ФАРШЕШАЛКА АРАСН АМК10 1Ф.

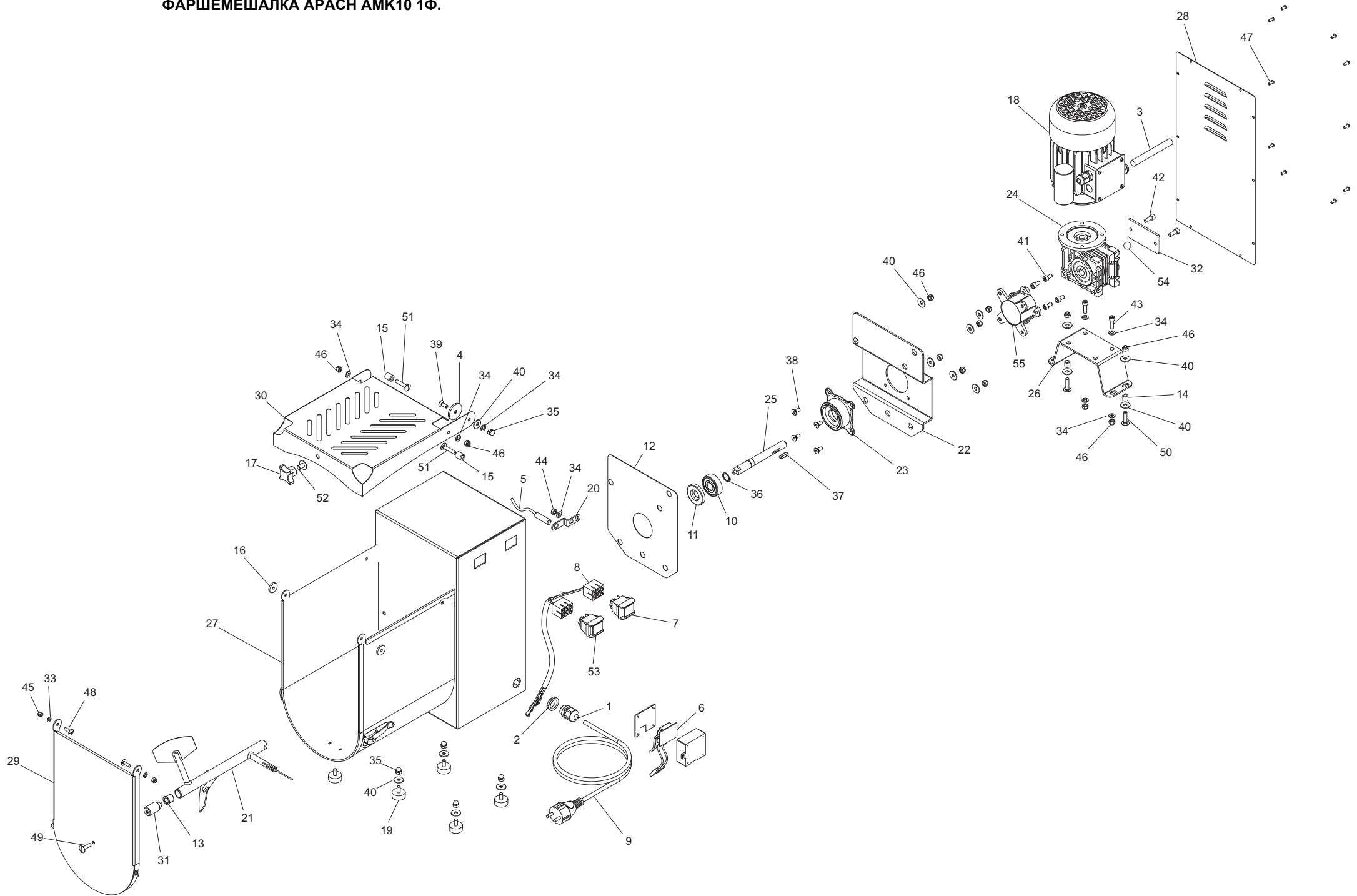

1	STRAIN RELIEF + NUT	LF1010063
2	DADO PLASTICA PG 11	LF1010072A
3	CAVETTO ALIMENT. MOTORE TF TC BZ	LF1030522030
4	MAGNET M634	LF1039710
5	LID MICROSWITCH	LF1043105
6	PCB IP10-20	LF1043140
7	INVER. COMELUX ON-ON ME 10-20	LF1043150
8	CAVO MOTORE C/ZOCCOLO 5X1 L=850	LF1043160
9	CAVO 3 X 1 CON SPINA SHUKO	LF1061005
09 CN	CAVO 3X1 CON SPINA CHINA 10A L=3000	LF1000416025
10	BALL BEARING 6302 2RS TC8	29320101
11	OIL GASKET 15X42X7 TC8	29561700
12	GUARNIZ.ANTIVIB.OMEGA ME10	LF1443112
13	BOCCOLA FLANG. JFM-1014-14 ME10-20	LF1443115
14	DIST. PLAST 10X6,2X10 COP. ME10-20	LF1443127
15	DIST. PLAST 12X6,4X13 ME10-20	LF1443133
16	RONDELLA PLAST. D 5,3X20 H3 ME30-50	LF1443301
17	SHARPENER LOCKING KNOB FOR SLICER	19562602
18	MOTOR PAM 63B 14 2P 230/50	LF1843103
19	RUBBER FOOT 25X10 _ CANOVA TOP	19560160
20	DOOR SUPPORT FOR MICROSWITCH	LF2007019
21	PADDLE IP10	LF2043119
22	OMEGA SUPPORTO MOTORE ME 10 MP COMP	LF2043123
23	FLANGIA RIDUTTORE ME 10 MP COMP	LF2043136
24	RIDUT. MNRV 040 63 I=50 ME 10 MP	LF2043140
25	PERNO TRASC. PALA ME 10 MP COMP	LF2043144
26	OMEGA SUPP. RID ME 10 MP COMP	LF2043147
27	CARENA COMPLETA ME 10 MP COMP	LF2043160
28	CARTER POST. ME 10 MP COMP	LF2043163
29	FRONTALE VASCA ME 10 MP COMP	LF2043166
30	COPERCHIO VASCA ME 10 MP COMP	LF2043169
31	PERNO PALA L=38 ME 10 MP COMP	LF2043172
32	PIASTRINA BLOCCO SFERA REGGIS M 10	LF2043185
33	WASHER DIN 125 D 5	IX2125005
34	FLAT WASHER DIN 125 D 6	IX2125006
35	CAP NUT DIN 1587 M 6	IX21587LC006
36	STOP RINGS DIN 471 D 15E	IX2471015
37	PIN DIN 6885/A 5X5X20	IX26885A050520
38	VITE TSPEI DIN 7991 M 6X14	IX27991006014
39	FLATHEAD CSK SCREW DIN 7991 M 6X16	IX27991PINTX616
40	WASHER LARGE DIN 9021 D 6X18	IX29021006018
41	SCREW TCEI DIN 912 M 6X12	IX2912006012
42	HEX SOCKET HEAD CAP SCREW DIN 912 M	IX2912006016
43	HEX.SOCKET HEAD CAP SCREW M6 X 20	IX2912006020
44	HEX.NUT DIN 934 M 6	IX2934006
45	DADO AUTOBLOCC. ES DIN 982 M 5 ALTO	IX2982005
46	LOCKNUT ES DIN 982 M6 ALTO	IX2982006
47	VITE POELIERS M 4X10	IX2POEL004010
48	VITE POELIERS M 5X16	IX2POEL005016
49	VITE POELIERS M 6X16	IX2POEL006016
50	VITE POELIERS M 6X20	IX2POEL006020
51	VITE POELIERS M 6X25	IX2POEL006025
52	VITE POELIERS M 8X12	IX2POEL008012
53	SWITCH COMELUX 401/L	LF1039201
54	BALL DIAM.13,5 _ TC 8 VEGAS	29320201
55	FLANGE MOTOR HOLDER _ TC 8 VEGAS	29561200
70	CONDENSATORE DA 20 UF	LF1011020